

1/8 SCALE  
PLASTIC MODEL KIT  
**RED SONJA**

Warriors, heed my advice!  
Check out the PRO TIP to  
bring my fierce spirit to life!



**RED SONJA**<sup>®</sup>

1/8 SCALE PLASTIC MODEL KIT

**X-PLUS**  
MODEL KIT  
KIT NO.  
411-200265TP

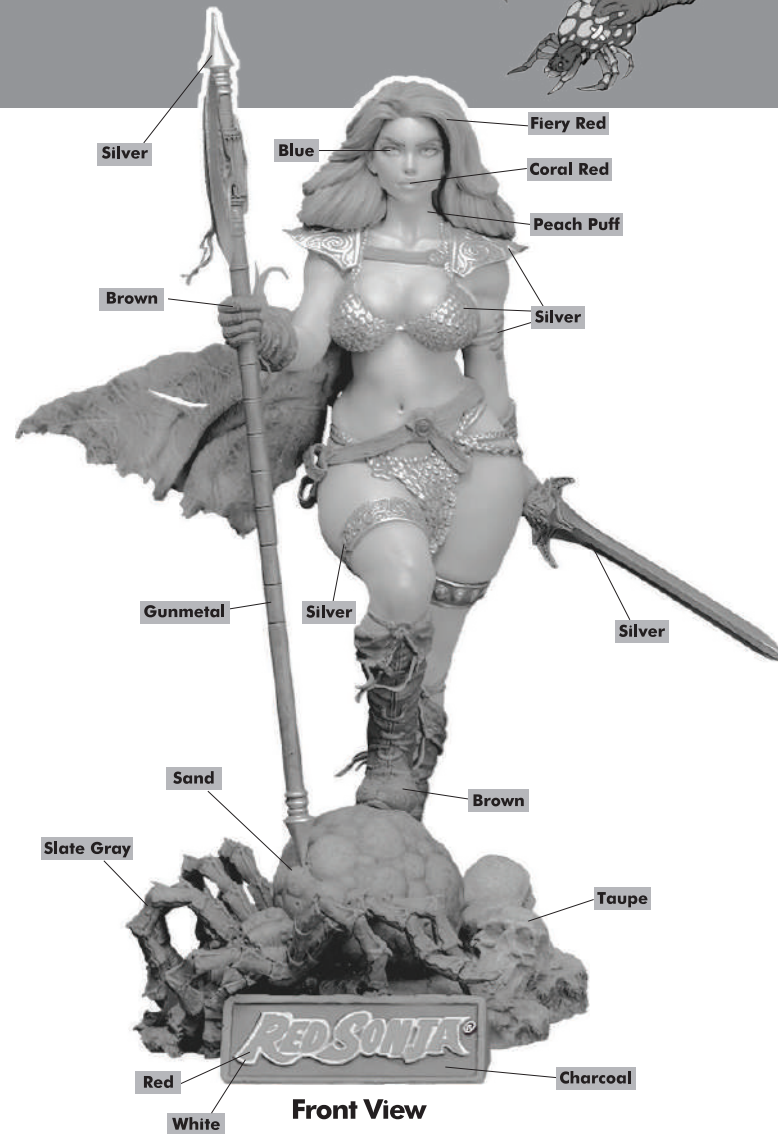
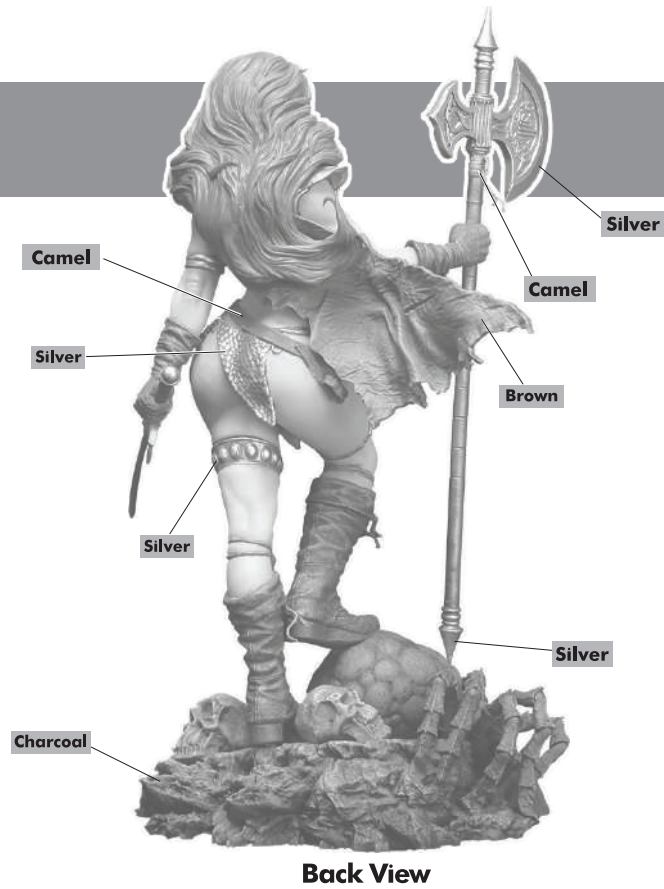

**IMPORTANT – READ THIS FIRST!**

- This model needs to be assembled. Please read the instructions carefully before assembling the model.
- After removing the product from the plastic bag, tear the plastic bag and dispose of it in a safe place, as there is a danger of suffocation if young children mishandle it.
- Carefully remove the parts from the trees and discard the trees after removing all parts.
- Due to the manufacturing process, sharp points may be present that could cause harm. Do not play with or mishandle the trees, and do not use them for anything other than their intended purpose. Households with young children should be particularly cautious.
- Use nippers to remove parts, and smooth any burrs remaining on parts with a craft knife or file. Exercise caution when using nippers, craft knives, or files, as they can cause cuts to hands or fingers. Children under 10 years old should have a parent or guardian carry out the work.
- This kit contains small parts that pose a choking hazard, so keep them out of reach of young children. Never leave a child younger than the target age unsupervised, as there is a risk of swallowing these parts.
- If using plastic cement or paint, pay close attention to the following points: In case of contact with eyes, immediately seek medical attention and follow safety instructions on the product packaging. Do not use cement or paint in enclosed areas due to the risk of inhaling toxic fumes. Never use cement or paint near an open flame, as it poses a fire hazard.
- Avoid leaving this product in areas exposed to direct sunlight, high temperatures, or high humidity.



**PRO TIP!**

Red Sonja's iconic look is defined by her armor and weaponry, which play an important role in her fierce appearance. However, simply adding a metallic layer of paint might leave something to be desired in terms of realism and depth. Here's a tip to have a more realistic metal-like finish:

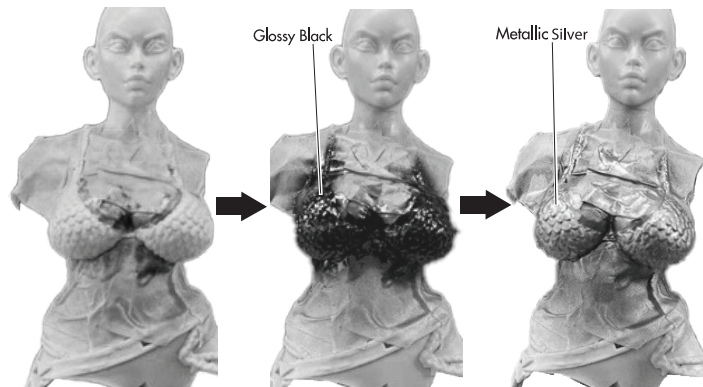

- ① Cover the areas around where you want to paint with masking tape for a cleaner result.
- ② Apply a layer of black under-painting on the areas where you want the metallic effect.
- ③ Finish by painting the area with metallic paint.

Note: Make sure to use glossy black as matte paints will not create the same shiny finish.

**KEEP AN EYE OUT FOR THIS KIT TOO!**

FOR MORE TUTORIALS AND FUN STUFF VISIT [www.xplusmodelkit.com](http://www.xplusmodelkit.com)

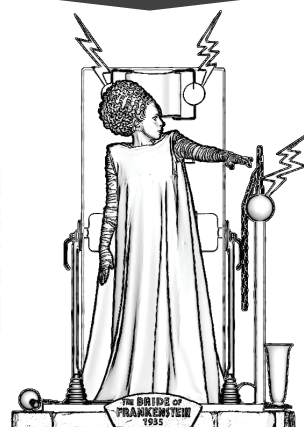

**SURVEY!**



**CONTACT US**

ADDRESS: 9F, Hiranomachi Takahashi Bldg., Hiranomachi 1-8-8, Chuo Ward, Osaka City, Osaka, Japan 541-0046

EMAIL: [info@ric-toy.com](mailto:info@ric-toy.com)

\*We are available on non-holiday weekdays from 10:00 to 18:00 (JST)

2025  
**X PLUS CO., LTD.**

MADE IN CHINA

RED SONJA<sup>®</sup> & © 2025 and related logos, characters, stories, names, and distinctive likenesses thereof are owned by Red Sonja LLC.

FOR SUGGESTED DETAIL PAINTING SCHEME - SEE ILLUSTRATIONS.  
Paint parts as indicated and allow to dry before assembling.

# FIG.1

## Step 1: Assembling the torso

Attach Torso (Back) #2 and Torso (Front) #3 together. Then, attach #4 to the left and #5 to the right side. Attach Face #1 on the head part of Torso (Back) #2, then finish the torso by attaching Bikini Top #7 to the front side.

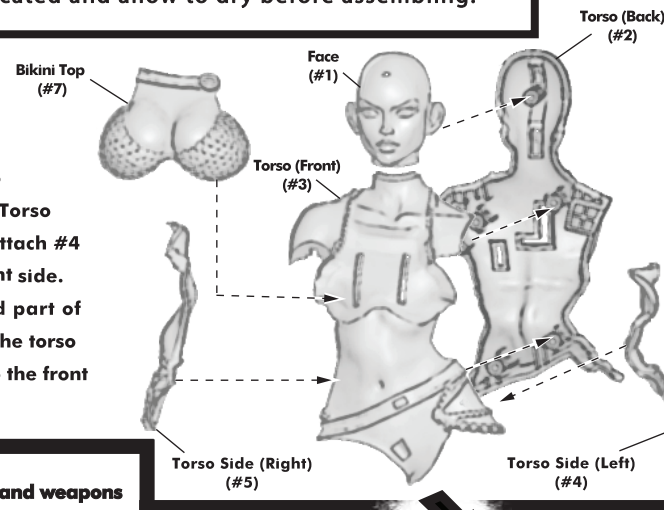

## Step 2: Assembling the limbs and weapons

### 1. Right Arm and the Axe:

Attach Axe Head #6 to Right Hand (Front) #28. Attach Axe Grip #31 to the axe handle part of Right Hand (Front) #28, then clamp Right Hand (Back) #25 over the assembly. Insert the assembly between Right Arm Halves, #57 and #58. Finish the axe and right arm by attaching Axe Ribbons #16 to #6 and Glove Ribbons #21 to the assembly.

### 2. Left Arm and the Sword:

Attach Cross-guard #27 to Sword #29. Then clamp in the assembled sword between Left Hand (Back) #26 and Left Hand (Front) #30. Finish the left arm by inserting the assembled left hand and sword between Left Arm Halves #59 and #60.

### 3. Left Leg:

Attach Left Leg Halves #53 and #54 together. Then attach the left thigh band pieces, #10 in front, #9 and #11 on the sides and #8 on the back. Next, clamp in the left boot's sides #64 and #65, then insert Left Boot Sole #66 to the bottom. Attach the assembled boot to the assembled leg and attach the Left Boot Ring #19 to the top of the boot. Complete the left leg by attaching the boot's strings #14 and #23 to the left side and #24 to the right.

### 4. Right Leg:

Attach Right Halves #55 and #56 together. Attach the thigh band pieces #17 and #18 to the back side and #12 to the front side. Clamp in Right Boot Halves #62 and #63. Then insert Right Boot Sole #67. Attach the assembled boot to the assembled leg, Then attach the Right Boot Ring #20 on top of the boot and attach the strings #15 and #22 to the left and #13 to the right side.

## Step 3: Assembling the Figure

Attach the assembled limbs to the torso. Then Attach Right Shoulder Pad #50 to the right shoulder and Left Shoulder Pad #51 to the left. Attach Bikini Bottom (Front) #68 to the lower part of the front torso and Bikini Bottom (Back) #69 to the back side. Then attach Belt Knot #61 to the middle and Sword Frogs #43 and #44 to the right side of the belt.

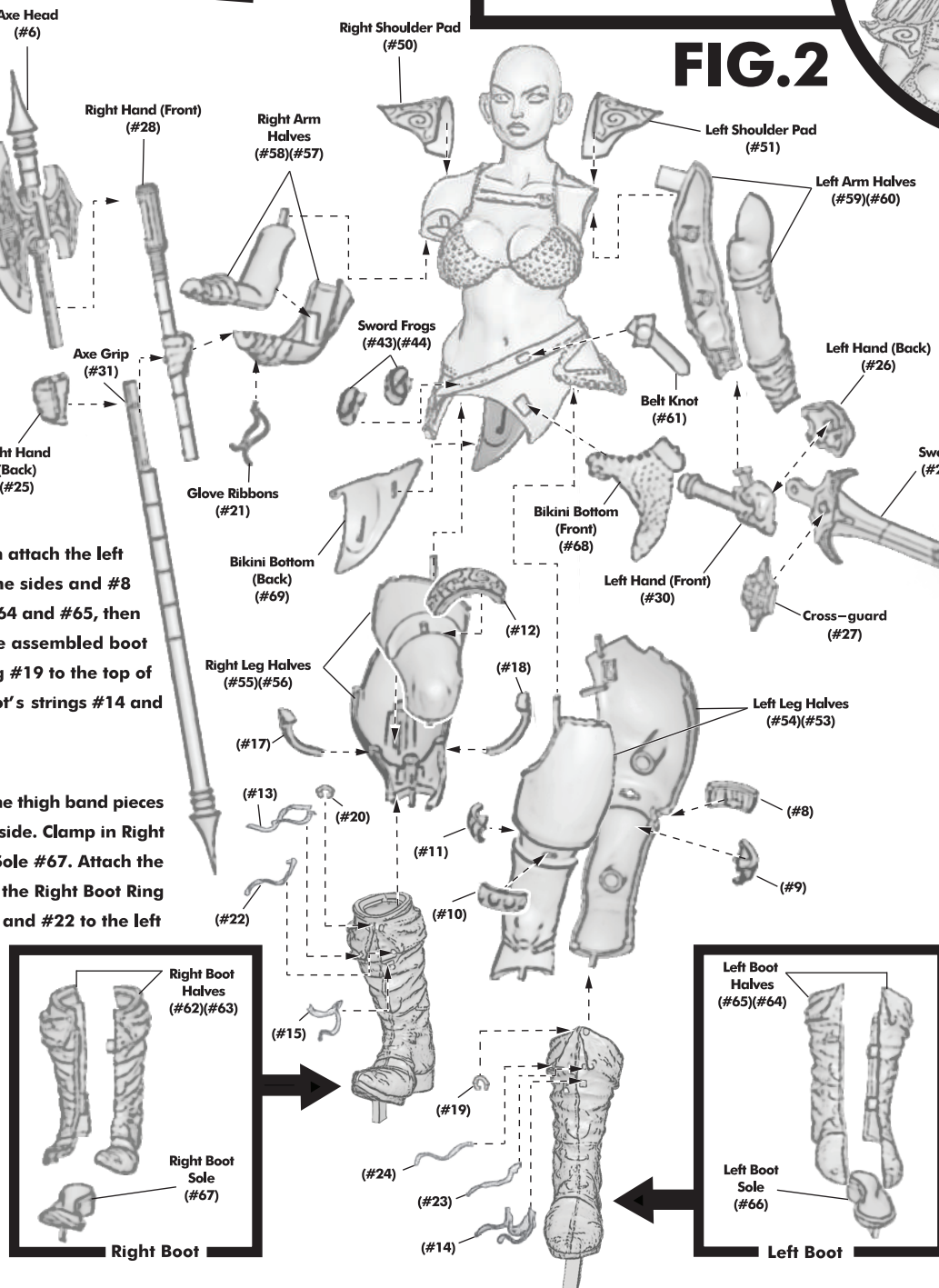

# FIG.3

## Step 4: Assembling the hair

Attach Cape #52 to the back side of the assembled figure, then attach #34 to the inner lower side of Hair Base #33 before attaching it to the cape. Next, attach #39 to #40 and attach them to the hair base. Attach #38 on the right side of #40 and #46 next to it. Next, attach #32, to the lower side of #33. Attach #47 and #49 to #48, and then attach the assembly to the right shoulder. Finally, attach #45 to #36 and attach them to #33.

On the front side, attach #41 next to #40, followed by #35 and then #37. Complete the hair assembly by attaching #42 on the top front side of the structure.

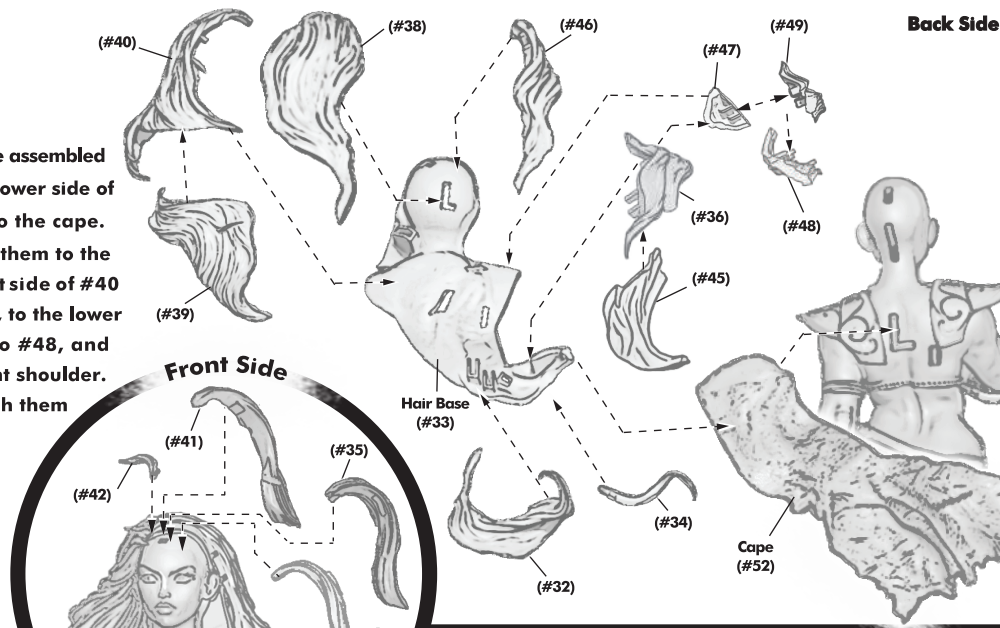

# FIG.2

# FIG.4

## Step 5: Assembling the platform and spider

Start by attaching platform parts #70 and #71 together, then insert Nameplate #94 onto the front side of the platform.

For the spider's body, begin by attaching sides #89, #92, and #93. Then, attach part #90 on top. Assemble the head by clamping head parts #80 and #91 together, and set the assembled head aside.

For the legs, test the fit before applying glue to ensure proper alignment. On the right side, start by attaching Rear Leg (Right) #82 to the corresponding side of the body. Next, connect parts #88, #84, and Front Leg (Right) #83 together. Then, attach them to the body. On the left side, attach Rear Leg (Left) #85 to the left side of the body. Then attach #81, #86 and #87 in this order towards the front leg and attach the assembled legs to the body. Finish the spider's assembly by attaching the head to the front side of the body. Finally, attach the fully assembled spider to the base.

## Step 6: Assembling the skulls

Attach #74 to #77 for Skull (1). Proceed with Skull (2) by attaching #73 to #79, Skull (3) by attaching #72 to #78. Finish off by attaching #75 to #76 to form Skull (4).

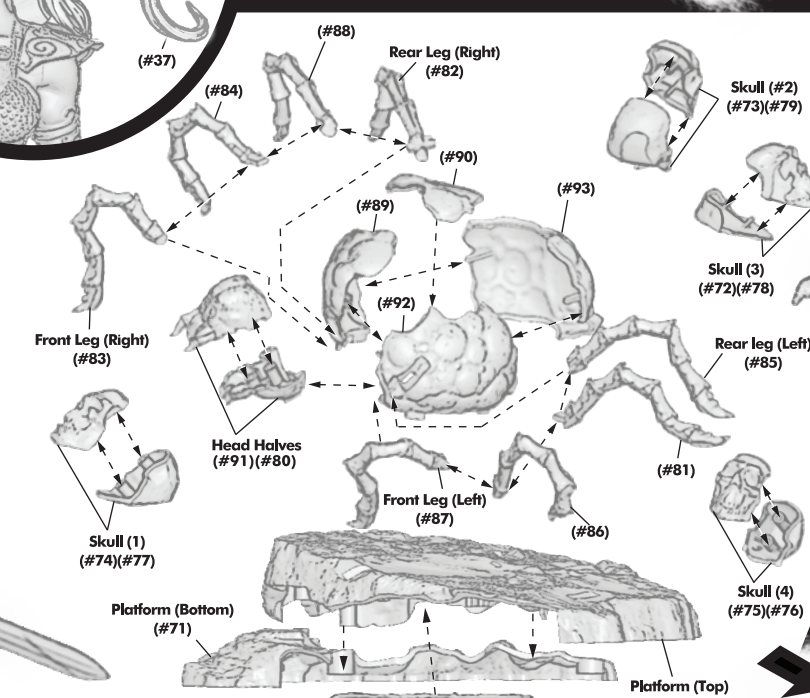

# RED SONJA®

**NOTE: PLEASE TEST FIT PARTS BEFORE GLUING TO ENSURE PROPER FIT.**

## Step 7: Assembling the Diorama

Place Skull (1) on the right side of the diorama and Skull (2) on the left back side. Then place Skull (3) and Skull (4) on the designated areas. Finish off the model by placing the assembled figure of Red Sonja on the base.

# FIG.5

